

NORTH TAHOE EVENT CENTER

@NorthTahoeEvents

www.NorthTahoeEvents.com

Events on the lake

Located directly on the sandy shores of North Lake Tahoe in Kings Beach, our venue offers a stunning lakeside setting for your next unforgettable gathering. From community celebrations and private parties to festivals and fundraisers, we provide everything you need to bring your vision to life.

Our spacious facility accommodates up to 500 guests and includes upgraded event essentials like staging, podiums, tables, linens, chairs, and bars. With flexible catering and bar options, plus easy walking access to nearby hotels and restaurants, planning your event here is effortless and enjoyable.

Let us take care of the details so you can focus on what matters most.

Additional Discounts Available

Multi Day bookings discount

Cold Season Discount (must take place between November - April)

NTPUD Resident Discount: Additional 20%

Building Info

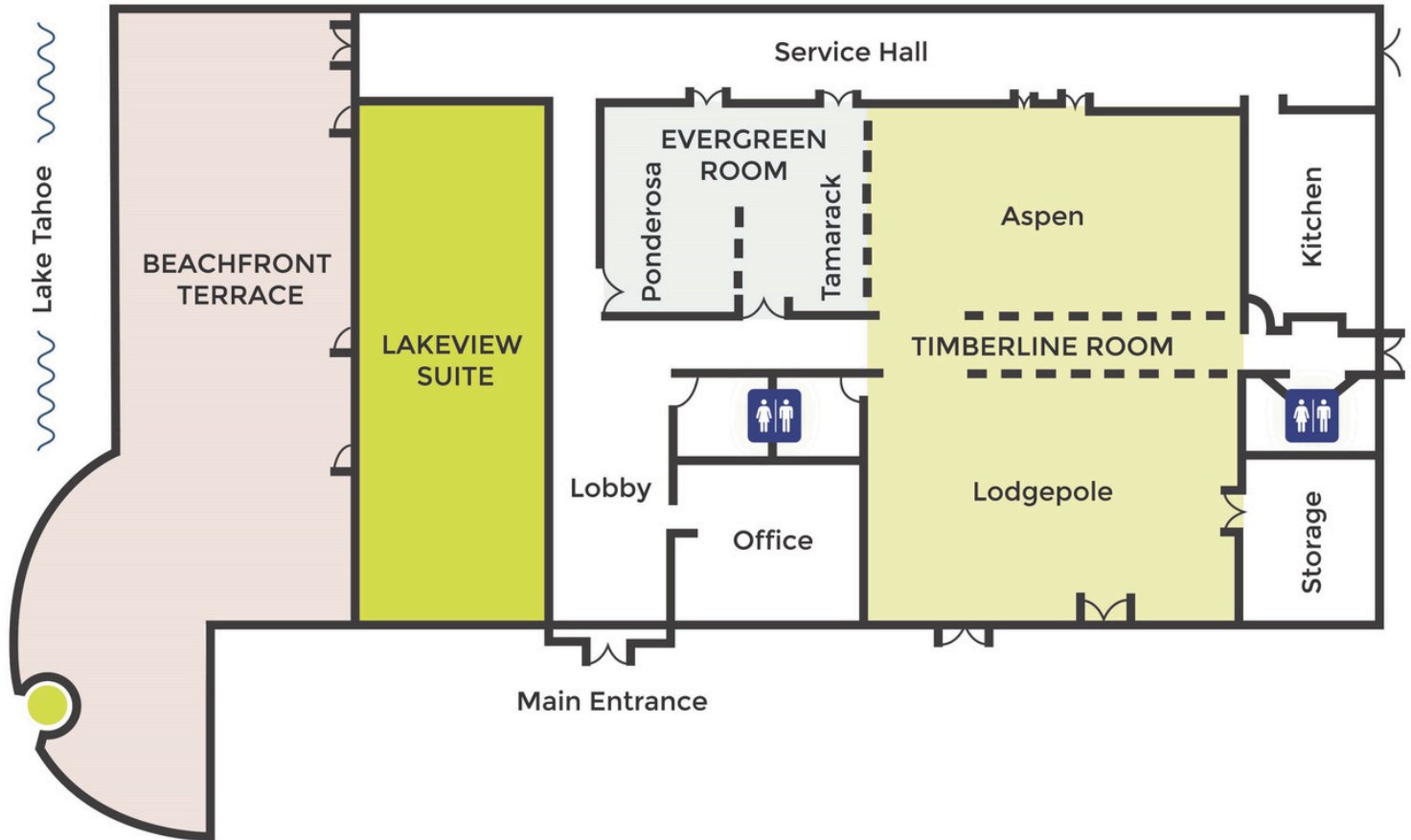

Room Name	Room Dimensions	Square Ft	Ceiling Ht.	CAPACITY		
				Theater 10 chairs per row	Classroom (2 per 6' table)	Reception 60" tables 10 per table
Terrace	118' x 35'	4130				200
Lakeview	24' x 83'	1992	11'	150	70	130
Evergreen	42' x 30'	1260	11'	100	50	90
Ponderosa	20' x 34'	680	11'	50	20	40
Tamarack	22' x 30'	660	11'	50	20	40
Timberline	59' x 82'	4838	11'	400	144	300
Aspen	59' x 35'	2065	13'	200	72	130
Lodgepole	59' x 38'	2242	13'	225	72	150

LAKEVIEW CELEBRATION RATES

INCLUDES LAKEVIEW ROOM AND TERRACE

Max Capacity: 150	May- Oct	Nov- April
Monday - Thursday		
Hourly	\$825	\$775
Daily	\$5,000	\$3,500
Friday		
Hourly	\$1,325	\$825
Daily	\$8,000	\$5,500
Saturday & Holidays		
Hourly	\$1,575	\$975
Daily	\$9,500	\$7,000
Sunday		
Hourly	\$1,075	\$750
Daily	\$6,500	\$4,500

HOURLY RENTAL 3 HOUR MINIMUM

OTHER ROOM RATES

Timberline Event				
Full Room: 300			Half Room: 150	
	May- Oct	Nov- April	May- Oct	Nov- April
Monday - Thursday				
Hourly	\$450	\$400	\$300	\$200
Daily	\$2,700	\$2,300	\$1,600	\$1,300
Friday				
Hourly	\$600	\$425	\$350	\$250
Daily	\$3,500	\$2,500	\$2,100	\$1,500
Saturday & Holidays				
Hourly	\$700	\$500	\$425	\$325
Daily	\$4,150	\$3,000	\$2,500	\$1,800
Sunday				
Hourly	\$600	\$425	\$350	\$250
Daily	\$3,500	\$2,500	\$2,100	\$1,500

Entire Building Rental		
Entire Building: 500		
	May- Oct	Nov- April
Monday - Thursday		
Hourly	\$1,100	\$800
Daily	\$6,500	\$5,000
Friday		
Hourly	\$1,600	\$1,200
Daily	\$9,500	\$7,000
Saturday & Holidays		
Hourly	\$1,800	\$1,400
Daily	\$11,000	\$8,500
Sunday		
Hourly	\$1,300	\$1,000
Daily	\$8,000	\$6,000

HOURLY RENTAL 3 HOUR MINIMUM



INCLUDED ITEMS

- White Folding Chairs (*on pavers only*)
- 6 Cocktail Tables
- Water Station
- Wooden Cross Back Chairs (up to 150 qty)
- White or Black Linens
- White or Black Napkins
- 5 ft Round Guest Tables - fits 8-10 guests
- As many swag/ check in/ dessert/buffet tables you need
- Indoor Dance Floor
- Bars and Ice
- Glassware, Flatware, China and Bar Glassware
- Monitors
- Stage
- Podium

CATERING

We work with these local catering companies, we do require that you choose your caterer from one of these options.

You are welcome to choose the best fit for you!

Click on name to be directed to website

[Blend Catering](#)

[Roundabout Catering](#)

BAR

You bring in your own alcohol (any type you want)!

You will need to hire a licensed bartender.

All of the catering companies above provide a bartender with their catering staff.

We require that you purchase liquor liability insurance.

The liability insurance needs to be for at least a \$1,000,000 coverage and names the North Tahoe PUD as additionally insured.

[Check out an event insurance here](#)

Upgrades



**Ski Lift Chair with
Tahoe Sign**
\$400



Outdoor Gas Firepit
2 available
\$150 each



6 ft LOVE Letters
\$400



Outdoor Dancefloor
18 x 18
\$750



Outdoor Umbrellas
8 available
\$20 each



Outdoor Seating Sets
2 available
\$250 each

Timeline

Your 6 hour event can go as late as midnight.
You can add on as many additional hours to your rental as
you need.

Decorating and Pack up are included in your total event time

Example

5pm- 11pm Event	
5pm:	Decorating
6 pm:	Event Begins
9:30 pm:	Last Call
9:45pm:	Music Off
10 pm:	Event Ends, Clean Up
11 pm:	Building Locks

LOCAL GROUP ACCOMMODATIONS



Click name to go to website

- 1 min [Crown Motel...](#) up to 140 guests
- 3 min [Firelite Lodge...](#) up to 56 guest
- 3 min [Franciscan Lakeside Lodge...](#) up to 70 guests
- 4 min [Cedar Glen Lodge...](#) up to 100 guests
- 15 min [Hyatt Regency...](#)over 400 guests
- 15 min [Ritz Carlton...](#) over 400 guests
- 20 min [Martis Valley Lodge...](#) up to 109 guests

Off Property Restaurants

Click name to go to website

Next Door
[Jason's Beachside Grille](#)

0.1 miles
[Whitecaps Pizza](#)

0.4 miles
[Spindleshanks Restaurant](#)

0.5 miles
[Lanzas Restaurant](#)

[1.2 miles](#)
[Old Range Steakhouse](#)

1.5 miles
[Soule Domain](#)

3.9 miles
[Gar Woods Grill and Pier](#)

Things to Do



On Property

Full Beach Rental Set Up, Paddle Boards, Kayaks, Games
Team Building

Kayak and Stand Up Paddle Boards Individual Rentals

Lakeview Wood Saunas

0.2 miles
North Tahoe Watersports

0.5 miles
Snowmobile Tours

1.5 miles
Boat Rentals

2.2 miles
Tahoe Vista Tree Top Adventure

8 miles
Northstar Village Ice Skating

NEARBY PARKING OPTIONS



Tart Connect
local transportation service

Offers curb-to-curb, on-demand service for any trip within the defined service areas at no charge (check app for zones).



FAQs

Can we add on time to our rental?

You can add additional hours for a fee of \$500 per hour.

Is the beach area included?

The beach between our venue and Lake Tahoe is part of CA State Parks and is open to the public, and you have the option for a portion of your event to take place on the sand. Most beach goers are respectful of weddings and we set up fencing and signage to let the public know there will be an event.

Is there a back up plan for bad weather?

We always have an option to move your entire event inside.

Can I bring my own bar?

You bring in your own alcohol, soft drinks, mixers and garnish. All alcohol must be served by a certified bartender, with a current RBS card. You will also need to purchase an insurance policy, which we will send details for once you book. All professional caterers can provide a bartender. We comply with all state laws regarding alcohol.

What time does our event need to end?

County ordinances is that outside music must be off at 10 pm (last song at 9:45pm). All speakers & lights on terrace are turned off, with doors closed at 10 pm. Inside music is a hard stop at 11 pm (last song at 10:45pm).



Contacts



Text: 530-231-1220



530-546-7249



NorthTahoeEvents



8318 N Lake Blvd
Kings Beach 96143



Events@
NorthTahoeEvents.com



NorthTahoeEvents.com

NORTH TAHOE EVENT CENTER